

LEGEND

- ☎ TELEPHONE
- Ⓢ BANK MACHINE
- 📶 INTERNET BOARDS
- ▨ NON USEABLE AREA
- ♂ WOMEN'S WASHROOM
- ♀ MEN'S WASHROOM
- ♿ WHEELCHAIR ACCESSIBLE
- COLUMNS
- 🚒 HOSE VALVE STATION
MUST BE KEPT ACCESSIBLE & VISIBLE
- Ⓢ ATM/BANK MACHINE
- ← OPERABLE PARTITION
- 🚒 FIRE HOSE CABINET
MUST BE KEPT ACCESSIBLE & VISIBLE
- 🔥 FIRE EXTINGUISHER
MUST BE KEPT ACCESSIBLE & VISIBLE
- 🚒 FIRE EXTINGUISHER CABINET
MUST BE KEPT ACCESSIBLE & VISIBLE
- 🚒 PULL STATION
- 🚪 FIRE EXIT
- 📞 FIREFIGHTERS TELEPHONE

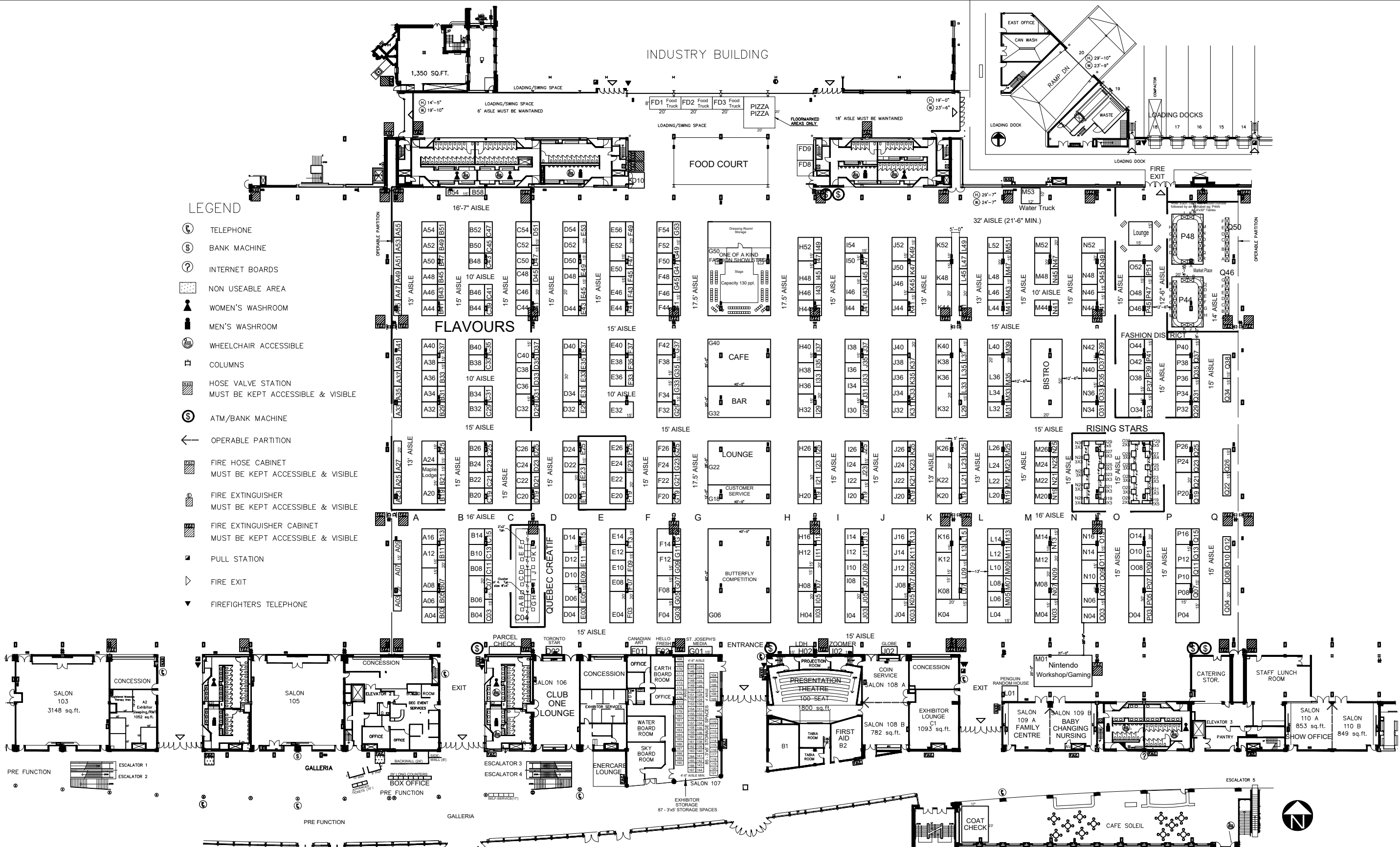

ONE OF A KIND SHOW-SPRING 2020
Enercare Centre-Halls B-C
March 25 - 29, 2020

Floor plan dated 6th March, 2020

- Drawn by D.R.
 Date: 02/05/2019
 Rev #1: 16/07/2019
 Rev #2: 10/09/2019
 Rev #3: 29/01/2020
 Rev #4: 03/02/2020
 Rev #5: 11/02/2020
- Rev #6: 19/02/2020
 Rev #7: 21/02/2020
 Rev #8: 24/02/2020
 Rev #9: 25/02/2020
 Rev #10: 27/02/2020
 Rev #11: 05/03/2020
 Rev #12: 06/03/2020
- SUBJECT TO ON SITE
 VERIFICATION

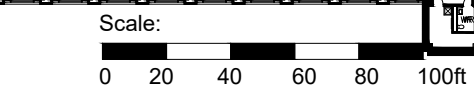

STRONCO

© 2018. All designs represented are the sole property of Stronco. Stronco retains the right to limit their application for reproduction.